



FEATURES & SPECIFICATIONS

INTENDED USE

Provides volumetric lighting by filling the entire volume of space with light, delivering the ideal amount of light to walls, cubicles, work surfaces and people. Typical applications include corridors, lobbies, conference rooms and private offices. RT5D will fill the space with light without glare or cave effect of traditional downlights. In addition, RT5D with a single 32W triple-tube lamp provides up to 30% energy savings when compared to common two-lamp, 26W double twin-tube downlight.

OPTICAL SYSTEM

Regressed, two-piece refractive system obscures the lamp and smoothly washes the reflector with light.

Impact modified acrylic prismatic refractor with polymer light diffusing film.

CONSTRUCTION

16-gauge galvanized steel mounting/plaster frame with mechanical trim retention integral yoke to retain optical system.

Rugged, one-piece white die-cast reflector system with linear facets softens and distributes light into the space (ships separately).

Mounting bars are 16-gauge galvanized steel with continuous 2-3/4" vertical adjustment, held in place with wingnuts. Post installation adjustment possible without the use of tools from above or below the ceiling.

Galvanized steel junction box with bottom-hinged access covers and spring latches. Two combination 1/2"-3/4" and three 1/2" knockouts for straight-through conduit runs. Capacity: 8 (4 in, 4 out) No. 12 AWG conductors, rated for 90°C.

Maximum 2" ceiling thickness.

ELECTRICAL SYSTEM

Horizontally mounted, four-pin, positive-latch, thermoplastic socket.

Class P, thermally-protected high power factor electronic ballast mounted to the junction box (EL battery back mounted on ballast tray). Minimum starting temperature is 0°F/-18°C.

Low operating temperature rating is -20°C.

S5 option available for use with SIMPLY5™ Lighting Intelligence system with multi-level dimming. See SYNERGY® Lighting Controls specification sheets for more information.

Lamp socket base: 26W-42W (GX24Q); 26W (GX24Q-3); 32W (GX24Q-3); 42W (GX24Q-4).

LISTING

UL Listed to US and Canadian safety standards. Damp location listed.

Protected by US Patent No. D553,781.

Catalog Number	
Notes	Type



RT5D

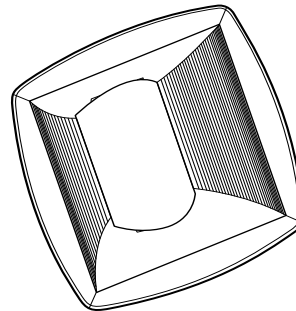

1' x 1'
Horizontal Lamp
Triple-Tube (TRT)

SIMPLY5™
LIGHTING INTELLIGENCE

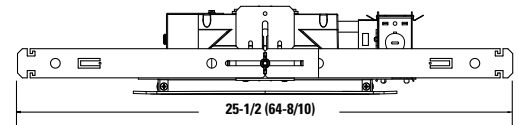

Specifications

Aperture: 10.625 (27.0)

Ceiling Opening: 11.25 X 11.25
(28.58 X 28.58)

Overlap Trim: 13.58 (34.49)

Height: 4.50 (11.43)

Length: 25.5 (64.77)

Standard Width: 15 (38.1)

EL Width: 16.5 (41.91)

All dimensions are inches (centimeters).

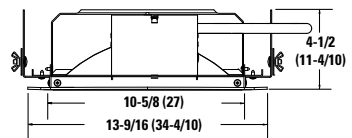
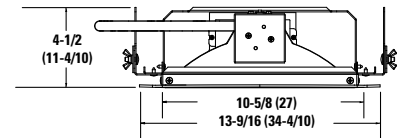

ORDERING INFORMATION

For shortest lead times, configure product using **standard options (shown in bold)**.

Example: RT5D

RT5D					
Series	Wattage/lamp		Voltage		Options
RT5D	(blank)	1/26-42TRT¹	(blank)	MVOLT²	EL Emergency battery pack; integral test switch provided^{4,5}
	1/26TRT	One 26W TRT lamp	120	120V ³	ELR Emergency battery pack; remote test switch provided^{4,5}
	1/32TRT	One 32W TRT lamp	277	277V ³	GMF Single, slow-blow fuse ^{3,4}
	1/42TRT	One 42W TRT lamp	347	347V ³	ADEZ Advance Mark 10™ electronic dimming ballast, 120V or 277V; minimum dimming level 5% ^{3,4}
	1/26DTT	One 26W DTT lamp			DMHL Lutron Compact SE™ electronic dimming ballast, 120V or 277V; minimum dimming level 5% ^{3,4}
					WLP 35K lamp (shipped separately)
					BDP Ballast disconnect plug (meets codes that require in-fixture disconnect)
					S5 1.0 ballast factor Simply5™ system ^{4,6}
					S5HW Hardwire for Simply5 system; replaces RELOC® wiring ^{4,6}
					CP Chicago Plenum ⁵

NOTES:

- 1 Not available with DMHL or WLP.
- 2 Electronic multi-volt ballast capable of operating any line voltage from 120-277V, 50 or 60Hz.
- 3 Wattage and voltage must be specified when ordering with GMF, ADEZ, DMHL and S5.
- 4 Not available in 347V.
- 5 Not available with EL or EL R option.
- 6 SIMPLY5 includes S' S5 MLC RELOC® wiring system (shipped separately). Available in 120V or 277V only.

Replacement parts:

Housing only: RT5D HSG U

Trim only: RT5D TRIM U

RT5D Volumetric Recessed Downlight

PHOTOMETRICS

RT5D, (1) 32W TRT lamp, 2400 rated lumens, s/mh 1.2 (along) 1.3 (across), test no. LTL15022

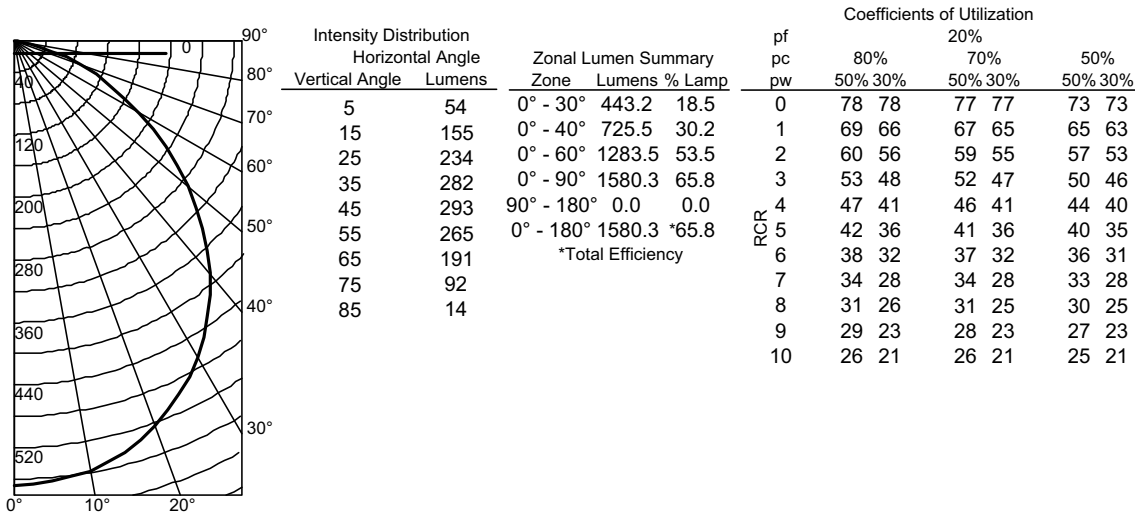

RT5D, (1) 42W TRT lamp, 3200 rated lumens, s/mh 1.2 (along) 1.3 (across), test no. LTL15019

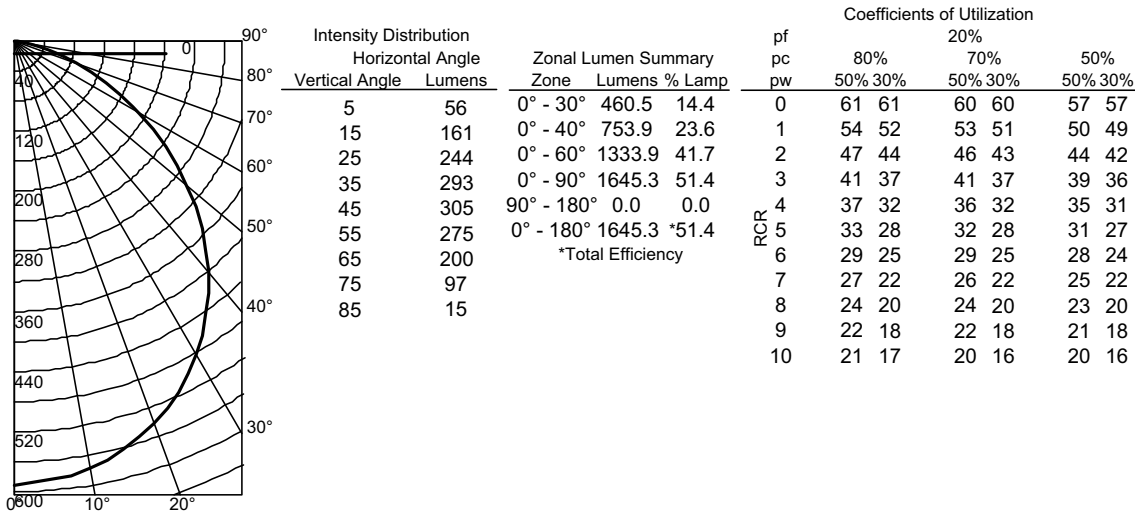

RT5D, (1) 26W TRT lamp, 1800 rated lumens, s/mh 1.2 (along) 1.3 (across), test no. LTL15023

